

## Inlet Fitting or Extend-A-Gun RC Installation Instructions

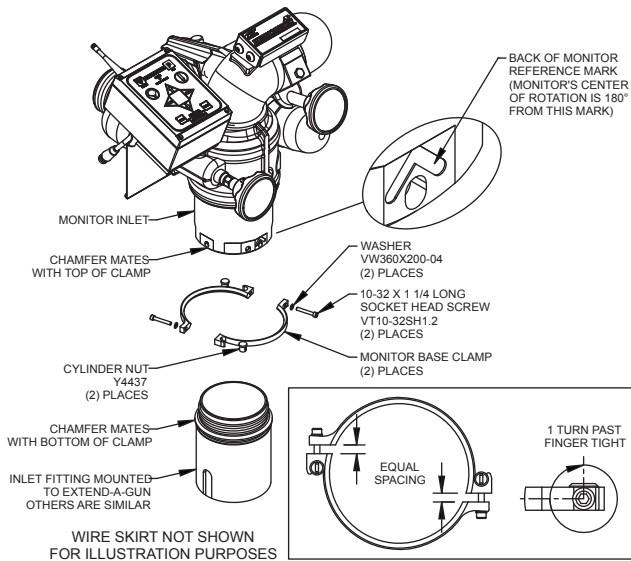

THREAD MONITOR ONTO EXTEND-A-GUN OUTLET FITTING UNTIL IT STOPS. UNTHREAD MONITOR UNTIL REFERENCE MARK IS IN DESIRED ORIENTATION. DO NOT UNTHREAD MONITOR MORE THAN ONE FULL TURN. APPLY BLUE LOCTITE TO THREADS ON NUT. INSTALL CLAMPS, SCREWS, WASHERS, AND CYLINDER NUTS AS SHOWN. TIGHTEN SCREWS UNTIL FINGER TIGHT, ENSURING EVEN SPACING BETWEEN BOTH ENDS OF THE CLAMPS AS SHOWN. TIGHTEN BOTH SCREWS AN ADDITIONAL 1 TURN PAST FINGER TIGHT USING A 5/32 HEX WRENCH. **CAUTION: OVERTIGHTENING SCREWS WILL DAMAGE CLAMPS.**

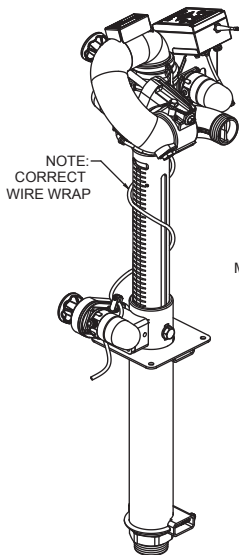

**CORRECT**

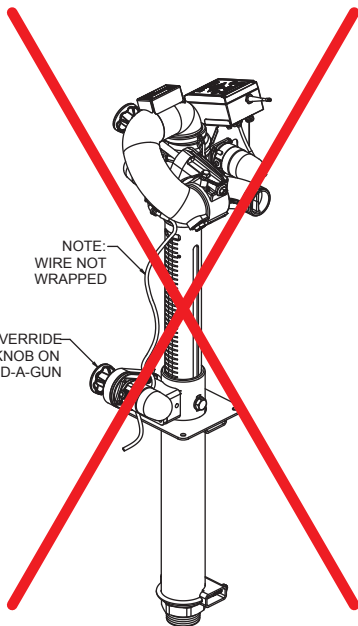

**INCORRECT**