

STORZ HYDRANT ADAPTER

INSTRUCTION FOR INSTALLATION, OPERATION, AND MAINTENANCE

⚠ DANGER

Understand manual before use. Operation of this device without understanding the manual and receiving proper training is a misuse of this equipment. Obtain safety information at tft.com/ serial-number.

This equipment is intended for use by trained and qualified emergency services personnel for firefighting. All personnel using this equipment shall have completed a course of education approved by the Authority Having Jurisdiction (AHJ).

This instruction manual is intended to familiarize firefighters and maintenance personnel with the operation, servicing, and safety procedures associated with this product. This manual should be kept available to all operating and maintenance personnel.

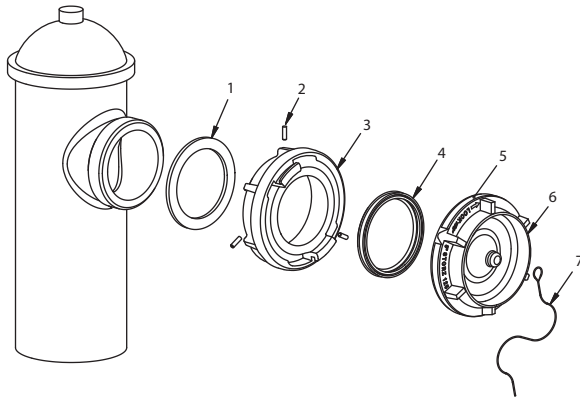

	DESCRIPTION	QTY	PART #
1	GASKET - 4.5" HOSE COUPLING (CUT)	1	V3210
2	1/4-20 X 3/4 SHSS - NYLON PATCH	3	VT25Y20SS750
3	HYDRANT ADAPTER 4.5" F X 5.0" STORZ	1	A4195-H
4	GASKET - 5.0" SUCTION GRAY - MOLDED	1	A4221
5	FLOW COLOR LABEL	1	A4190 - *
6	BLIND CAP - 5.0" STORZ	1	A4145-1
7	CABLE ASSEMBLY	1	VM1026

	US	METRIC
HYDROSTATIC PROOF TEST	900 PSI	62 bar
MAXIMUM OPERATING PRESSURE	300 PSI	21 bar
OPERATING TEMPERATURE RANGE OF FLUID	33 to 120°F	1 to 50°C
STORAGE TEMPERATURE RANGE	-40 to 150°F	-40 to 65°C
MATERIALS USED	Aluminum A356-T6 hard anodized MIL 8625 class 3 type 2, nitrile rubber, stainless steel	
CERTIFICATIONS	Meets requirements of NFPA 1960	
FLUID COMPATIBILITY	For use in fire water service	

DANGER

PERSONAL RESPONSIBILITY CODE

The member companies of FEMSA that provide emergency response equipment and services want responders to know and understand the following:

1. Firefighting and Emergency Response are inherently dangerous activities requiring proper training in their hazards and the use of extreme caution at all times.
2. **IT IS YOUR RESPONSIBILITY** to read and understand any user's instructions, including purpose and limitations, provided with any piece of equipment you may be called on to use.
3. **IT IS YOUR RESPONSIBILITY** to know that you have been properly trained in Firefighting and/or Emergency Response and in the use, precautions, and care of any equipment you may be called upon to use.
4. **IT IS YOUR RESPONSIBILITY** to be in proper physical condition and to maintain the personal skill level required to operate any equipment you may be called upon to use.
5. **IT IS YOUR RESPONSIBILITY** to know that your equipment is in operable condition and has been maintained in accordance with the manufacturer's instructions.
6. Failure to follow these guidelines may result in death, burns or other severe injury.

Fire and Emergency Manufacturers and Service Association, Inc.
PO Box 167, Lynnfield, MA 01902 • www.FEMSA.org
© 2020 FEMSA. All Rights Reserved.

1.0 SAFETY

WARNING

Damage or injury could result from operating this equipment beyond the specified operating pressure. Do not operate the device at pressures higher than the maximum operating pressure stated in the specification section.

CAUTION

Mismatched or damaged waterway connections may cause equipment to leak or uncouple under pressure. Failure could result in injury. Equipment must be mated to matched connections.

CAUTION

Dissimilar metals coupled together can cause galvanic corrosion that can result in the inability to uncouple the connection, or complete loss of engagement over time. Failure could cause injury. Per NFPA 1962, if dissimilar metals are left coupled together, an anti-corrosive lubricant should be applied to the connection and the coupling should be disconnected and inspected at least quarterly.

2.0 INSTALLATION

Apply color labels to the adapter and hydrant. Colors correspond to NFPA 291 flow ranges.

Screw the adapter to the hydrant and install (3) VT25Y20SS750 until tight.

BLUE	1500 GPM or more	Very good flows
GREEN	1000-1499 GPM	Good for residential areas
ORANGE	500-999 GPM	Marginally adequate
RED	Below 500 GPM	Inadequate

3.0 MAINTENANCE

The cap should be disconnected, cleaned and visually inspected inside and out at least twice annually, or as water quality and use may require. Seals shall be greased as needed with silicone-based grease such as Dow Corning 112. Any scrapes that expose bare aluminum should be cleaned and touched up with enamel paint such as Rust-Oleum. Replace any missing or damaged parts before returning to service.

WARNING

It is the responsibility of service technicians to ensure the use of appropriate protective clothing and equipment. The chosen protective clothing and equipment must provide protection from potential hazards users may encounter while servicing equipment. Requirements for protective clothing and equipment are determined by the Authority Having Jurisdiction (AHJ).

CAUTION

Any alterations to the product or its markings could diminish safety and constitutes a misuse of this product.

4.0 WARRANTY

Go to tft.com for all warranty information.

TASK FORCE TIPS LLC

MADE IN USA · tft.com

3701 Innovation Way, Valparaiso, IN 46383-9327 USA

800-348-2686 · 219-462-6161 · Fax 219-464-7155